

(D) Vor Montage bitte Gebrauchsanleitung lesen!

(GB) Please read the instructions of use prior to starting installation work!

(F) Prière de lire le mode d'emploi avant de procéder au montage !

(I) Prima del montaggio leggere per favore le istruzioni per l'uso!

(NL) Lees voor de montage de gebruiksaanwijzing door

(PL) Przed przystąpieniem do montażu przeczytaj instrukcję użytkowania!

WS60 / RECREA

1

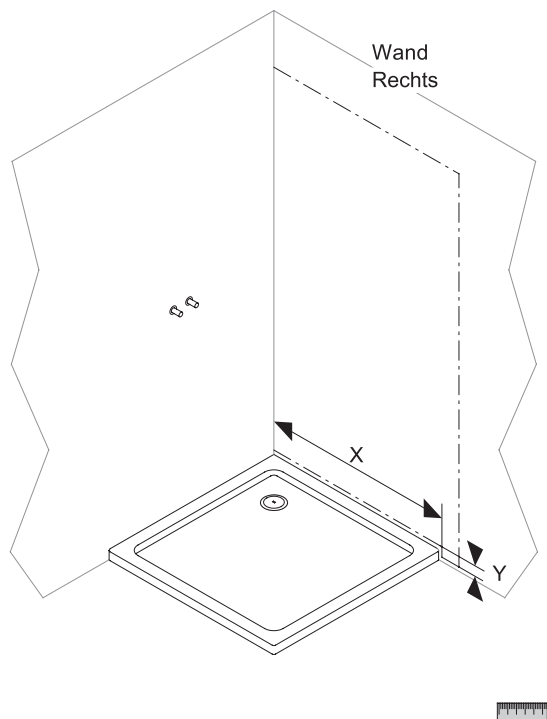

2

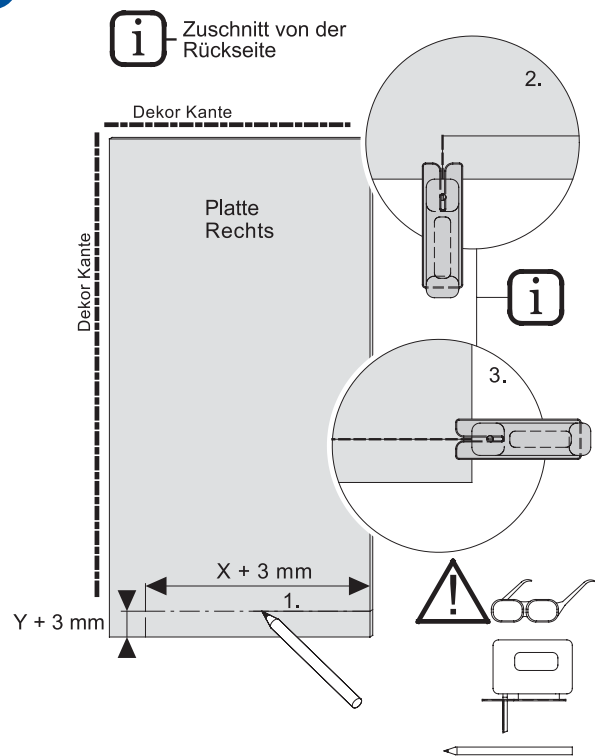

3

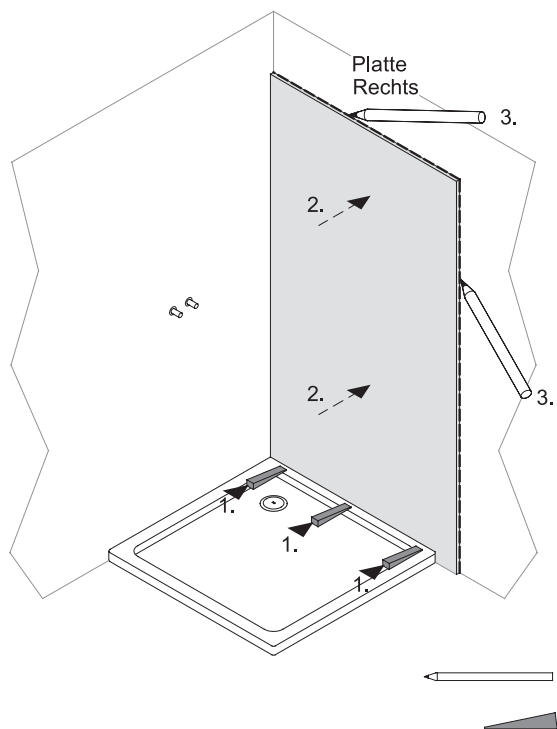

4

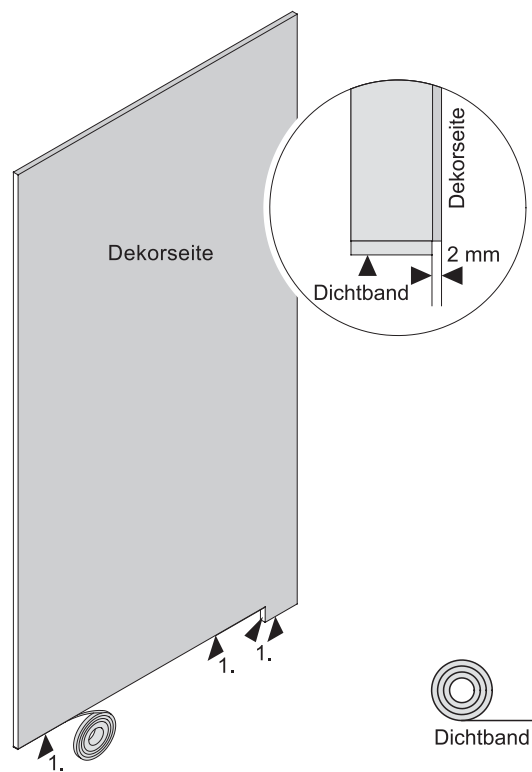

5

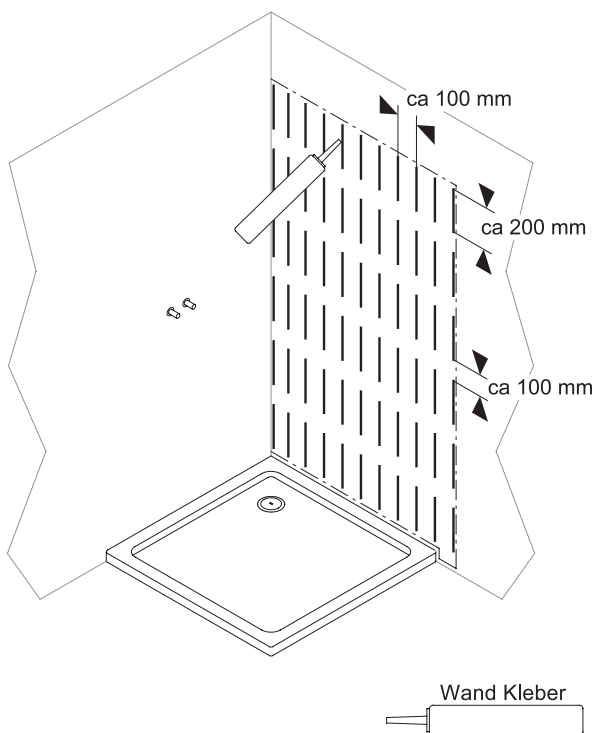

6

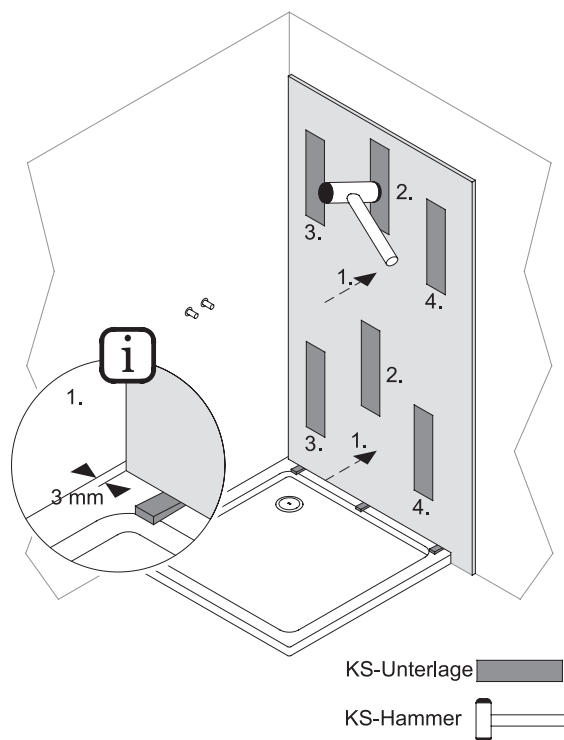

7

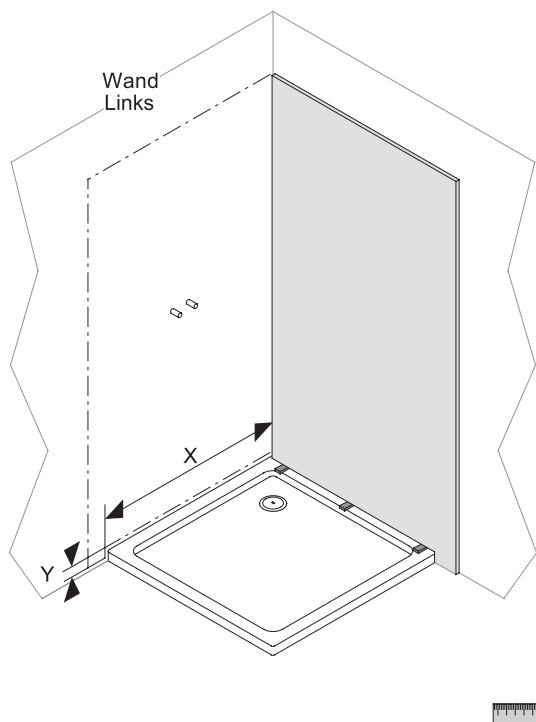

8

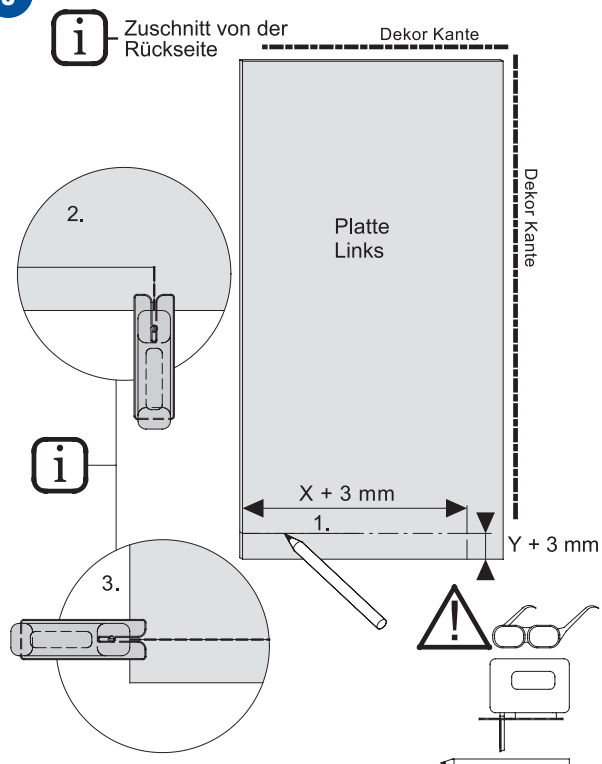

9

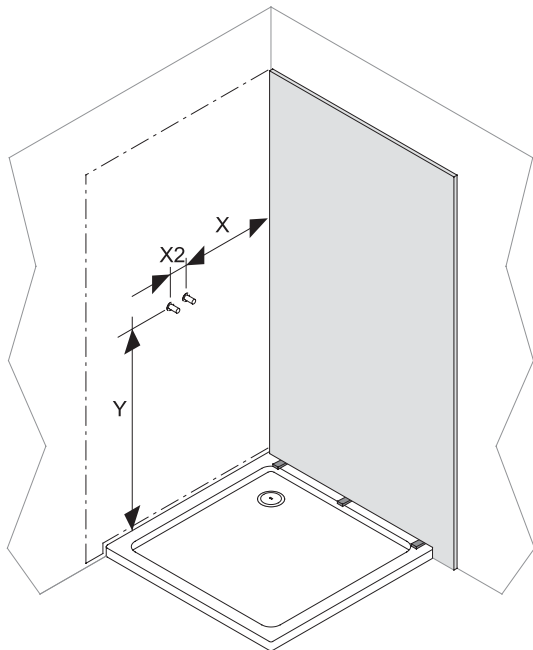

9b

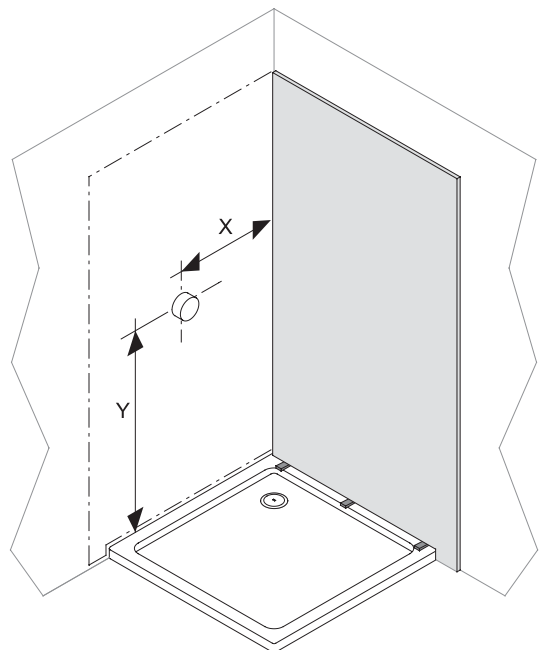

10

i Bohrungen von der Dekorseite durchführen

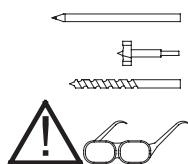
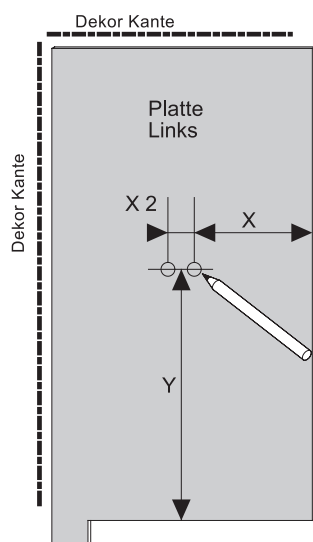

10b

Unterputzarmatur

i Zuschnitt von der Rückseite (Stichsäge)

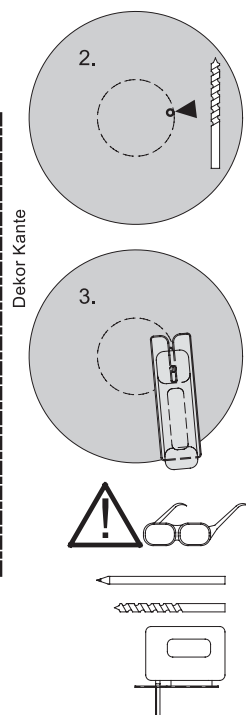
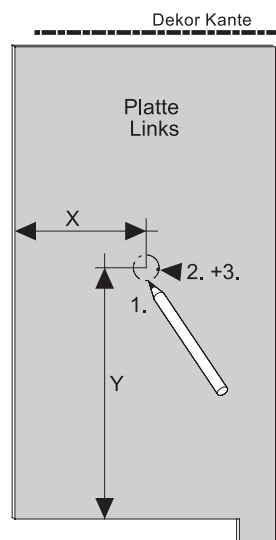

11

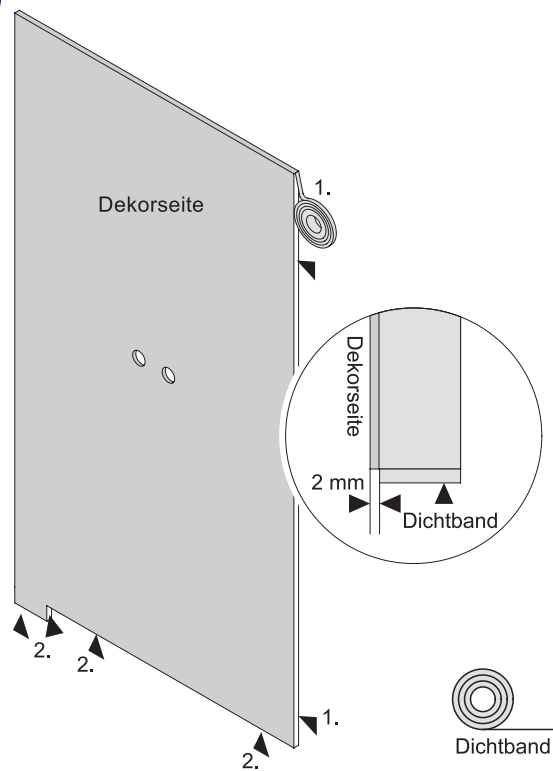

12

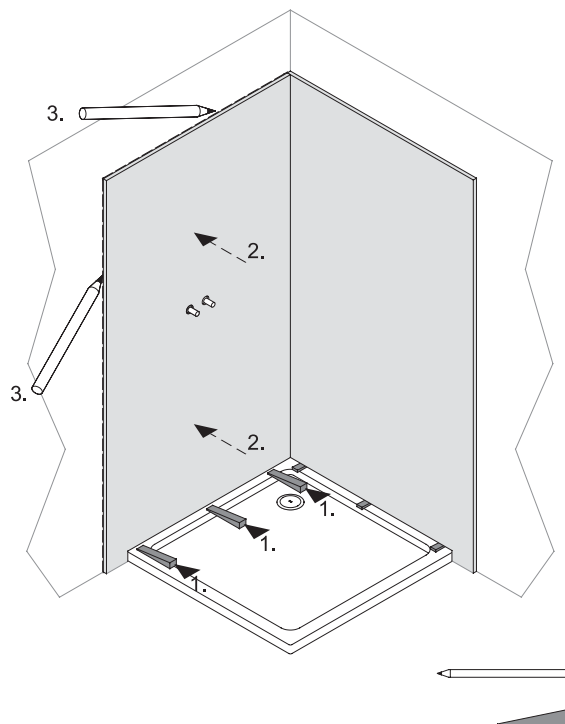

13

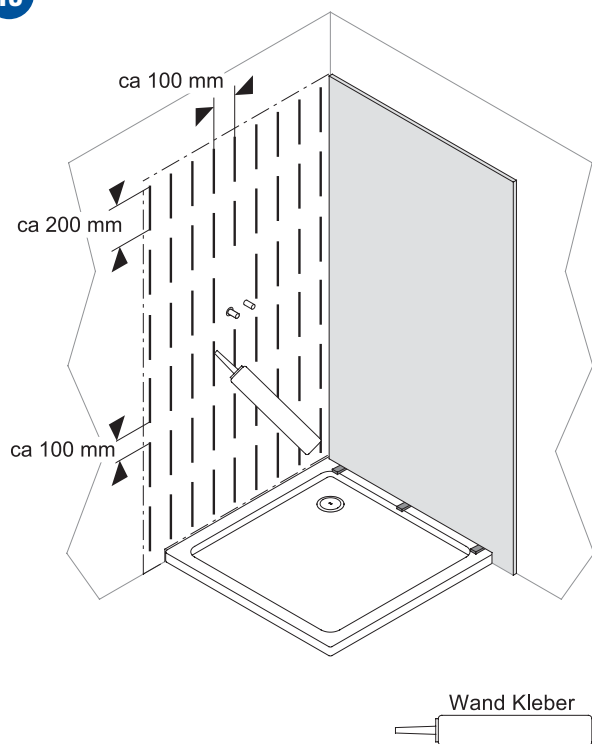

14

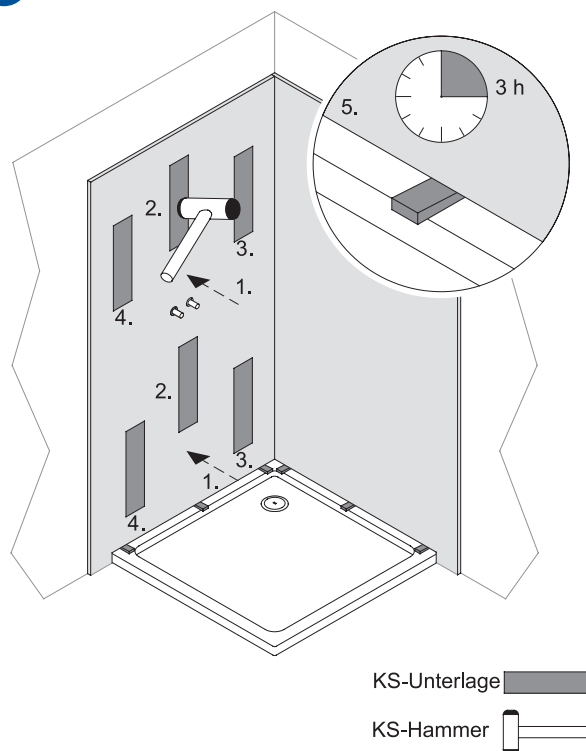

14b

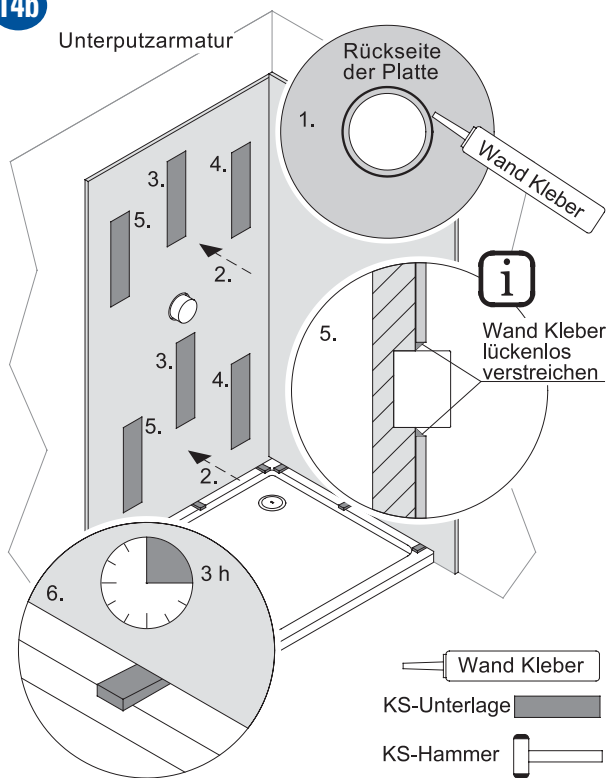

15

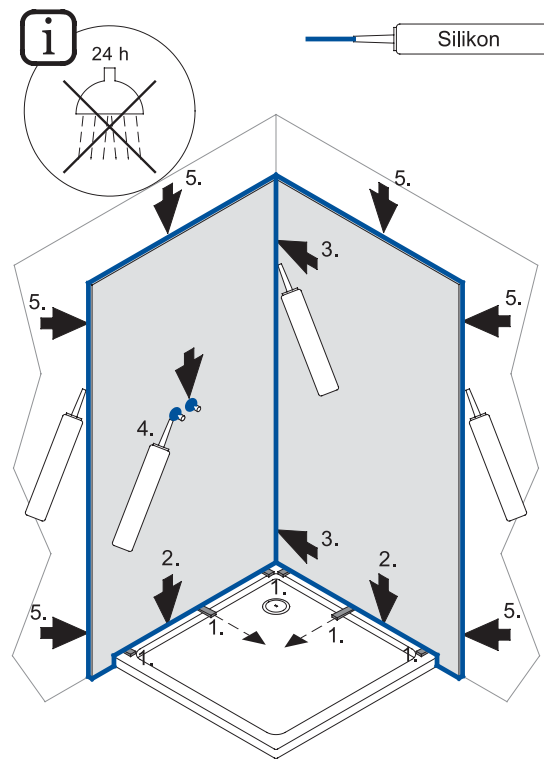

Ci riserviamo il diritto di apportare modifiche tecniche senza obbligo di preavviso. Decliniamo ogni responsabilità per errori in fase di stampa riguardanti i prodotti e/o loro specifiche tecniche.

Nous nous réservons le droit de procéder à des modifications techniques. Nous n'assurons pas de responsabilité pour des erreurs techniques ou des fautes d'impression.

Technische Veranderingen voorbehouden. Voor drukfouten en technische vergissingen stellen wij ons niet aansprakelijk.

We reserve the right to technical amendments. We do not take responsibility for printing errors or technical confusions.

Technische Änderungen vorbehalten wir uns vor. Für Druckfehler oder technische Verwechselungen übernehmen wir keine Gewähr.